

90° Elbows - Threaded
150# Heavy Pattern
304 Stainless Steel

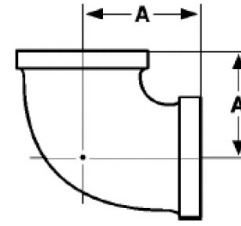

Inches / Pounds

Part #	Size	A	Approximate Weight (in Lbs.)
K90E.125S	1/8	0.71	0.05
K90E.25S	1/4	0.77	0.08
K90E.375S	3/8	0.94	0.12
K90E.5S	1/2	1.16	0.19
K90E.75S	3/4	1.26	0.30
K90E1S	1	1.44	0.52
K90E1.25S	1 1/4	1.73	0.71
K90E1.5S	1 1/2	1.91	1.07
K90E2S	2	2.24	1.45
K90E2.5S	2 1/2	2.70	3.26
K90E3S	3	3.09	4.66
K90E4S	4	3.82	7.05

****Stainless Castings conform to ASTM A351 ACI Grade CF8 (304)***

****NPT Threads on all fittings conform to ASME B1.20.1***

****Manufacturing facility is ISO 9001:2008***